

# BINGO



## Steel or 304 stainless steel high performance semi-electric stacker 200 kg

### FEATURES

- Worm drive electric motor provide control when lifting
- No oil needed
- 2 x braked casters and 2 x fixed wheels
- Built-in charger
- Painted steel frame and unpainted 304 stainless steel frame
- ABS plastic cowl and aluminum mast



**STAINLESS STEEL**



**STEEL**

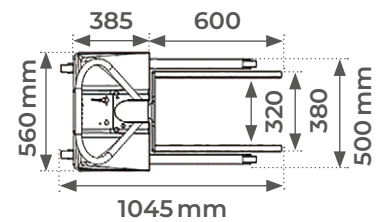
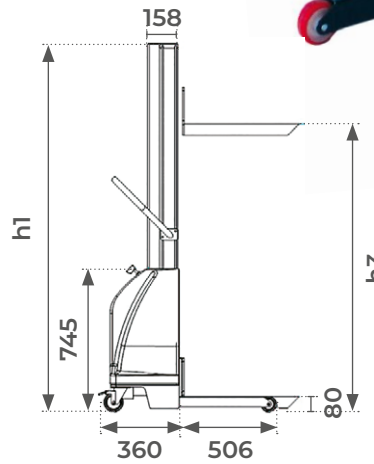

Photos and dimensions are not contractual. The manufacturer reserves the right to make any modification without notice.

Model		BINGO15	BINGO20	BINGO15/304	BINGO20/304
Material		steel	steel	304 stainless steel	304 stainless steel
Load capacity to 1500 mm	kg	200	200	200	200
Load capacity to 2000 mm	kg	-	150	-	150
Max. elevation <i>h3</i>	mm	1500	2000	1500	2000
Maximum mast height <i>h1</i>	mm	1920	2420	1920	2420
Engine power	W	300	300	300	300
Battery	V/Ah	2x12/38	2x12/38	2x12/38	2x12/38
Max. lifting speed	cm/s	8,3	8,3	8,3	8,3
Weight	kg	100	110	112	120

# BINGO



## Accessoires for BINGO steel or 304 stainless steel high performance semi-electric stacker



Control panel with integrated charger



Forks come standard



**BINGO-P**  
Nylon platform  
600x500 mm



**BINGO-BP**  
V-cradle  
600x400 mm



**BINGO-C**  
Load roller platform  
600x500 mm



**BINGO-R**  
Reel handler



**BINGO-S**  
Reel mandrel  
600 mm



**BINGO-G**  
Jib arm with lifting hook  
600 mm



**BINGO-SR**  
Roller mandrel  
540 mm



**BINGO-DS**  
Twin mandrel  
600 mm

**MORE ACCESSORIES AVAILABLE**

CONTACT US